

## Silicon Carbide Schottky Diode

### Features

- New Thin Wafer Technology
- Low Forward Voltage Drop ( $V_F$ )
- Zero Reverse Recovery Current
- Zero Forward Recovery Voltage
- Positive Temperature Coefficient on  $V_F$
- Temperature-independent Switching

$V_{RRM}$	=	650	V
$I_F (T_C \leq 135^\circ\text{C})$	=	19	A
$Q_C$	=	25	nC

### Benefits

- Replace Bipolar with Unipolar Device
- Reduction of Heat Sink Size
- Parallel Devices Without Thermal Runaway
- Essentially No Switching Losses

### Applications

- Switch Mode Power Supplies
- Uninterruptible Power Supplies
- Motor drive, PV Inverter, Wind Power Station

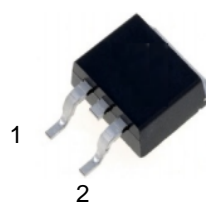

TO-263-2  
**Package**



Part Number	Package	Marking
SC3S06510HD	TO-263-2	SC06510

### Maximum Ratings

Symbol	Parameter	Value	Unit	Test Conditions	Note
$V_{RRM}$	Repetitive Peak Reverse Voltage	650	V	$T_C = 25^\circ\text{C}$	
$V_{RSM}$	Surge Peak Reverse Voltage	650	V	$T_C = 25^\circ\text{C}$	
$V_R$	DC Blocking Voltage	650	V	$T_C = 25^\circ\text{C}$	
$I_F$	Forward Current	38	A	$T_C \leq 25^\circ\text{C}$	
		19		$T_C \leq 135^\circ\text{C}$	
		10		$T_C \leq 158^\circ\text{C}$	
$I_{FSM}$	Non-Repetitive Forward Surge Current	86	A	$T_C = 25^\circ\text{C}, t_p = 8.3\text{ms}, \text{Half Sine Wave}$	
$P_{tot}$	Power Dissipation	150	W	$T_C = 25^\circ\text{C}$	Fig.3
$T_J, T_{STG}$	Operating Junction and Storage Temperature	-55 to 175	$^\circ\text{C}$		

## Electrical Characteristics

Symbol	Parameter	Typ.	Max.	Unit	Test Conditions	Note
$V_F$	Forward Voltage	1.27 1.38	1.5 1.6	V	$I_F = 10A, T_J = 25^\circ C$ $I_F = 10A, T_J = 175^\circ C$	Fig.1
$I_R$	Reverse Current	6 25	50 200	$\mu A$	$V_R = 650V, T_J = 25^\circ C$ $V_R = 650V, T_J = 175^\circ C$	Fig.2
C	Total Capacitance	640 66 48	/	pF	$V_R = 0.1V, T_J = 25^\circ C, f = 1MHz$ $V_R = 200V, T_J = 25^\circ C, f = 1MHz$ $V_R = 400V, T_J = 25^\circ C, f = 1MHz$	Fig.5
$Q_C$	Total Capacitive Charge	25	/	nC	$V_R = 400V, I_F = 10A$ $di/dt = 200A/\mu s, T_J = 25^\circ C$	Fig.4

## Thermal Characteristics

Symbol	Parameter	Typ.	Unit	Note
$R_{\theta JC}$	Thermal Resistance from Junction to Case	1	$^\circ C/W$	Fig.6
$R_{\theta JA}$	Thermal Resistance from Junction to Ambient	80	$^\circ C/W$	
$T_{sold}$	Soldering Temperature	260	$^\circ C$	

## RATING AND CHARACTERISTICS CURVES (SC3S06510HD)

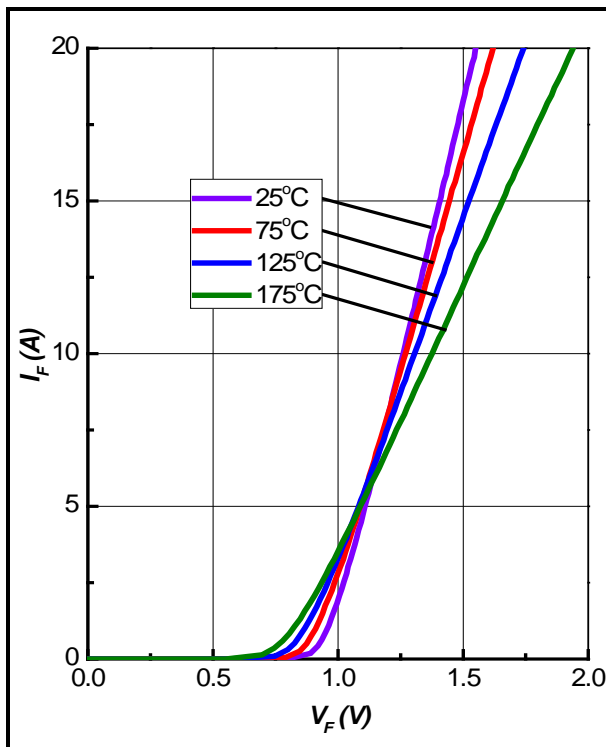

Figure 1. Forward Characteristics

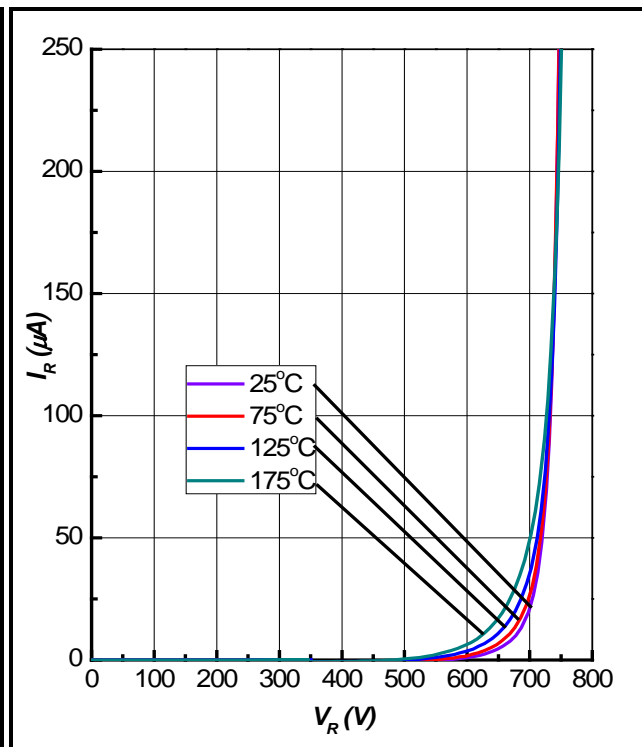

Figure 2. Reverse Characteristics

## RATING AND CHARACTERISTICS CURVES (SC3S06510HD)

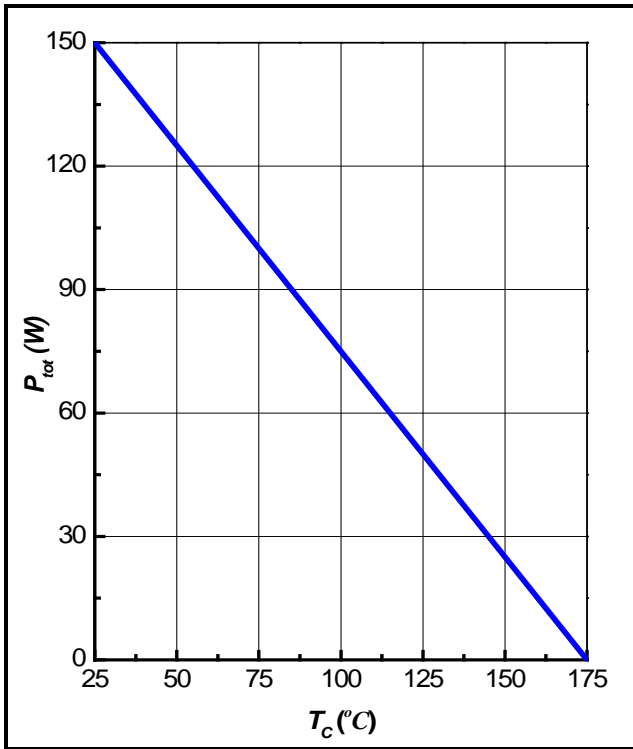

Figure 3. Power Derating

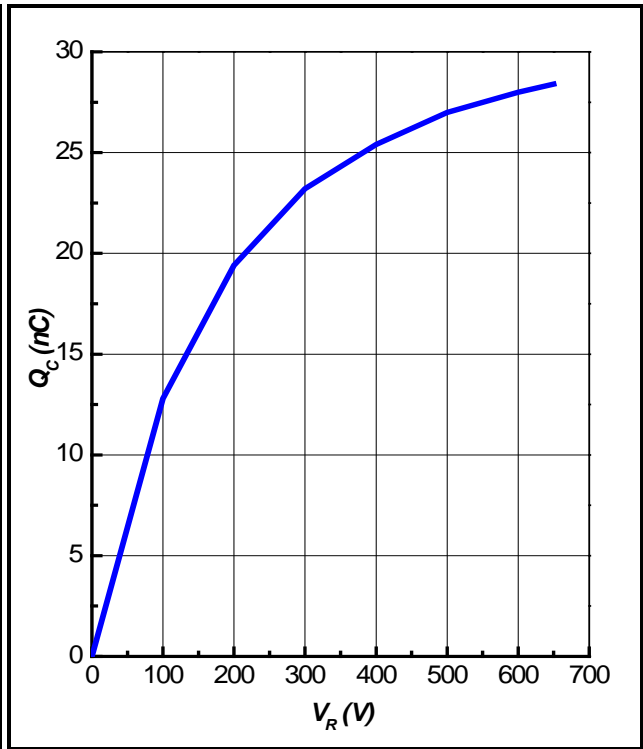

Figure 4. Total Capacitive Charge vs. Reverse Voltage

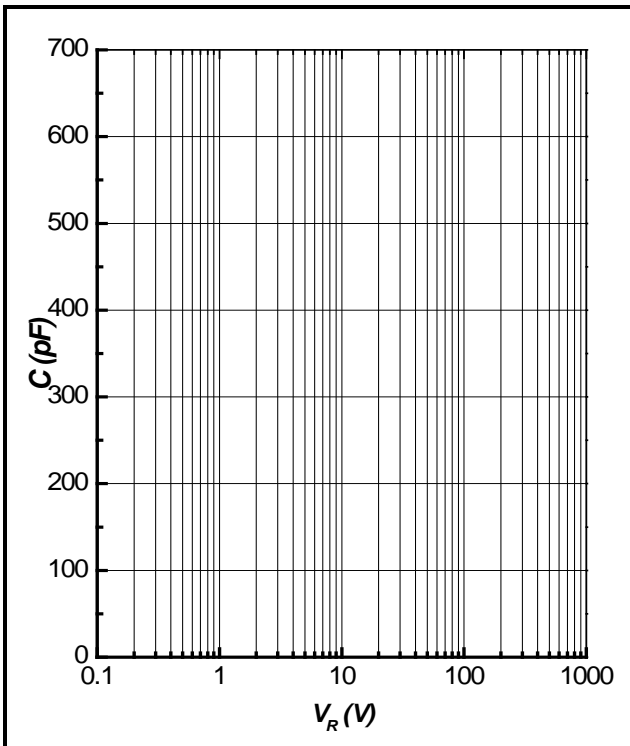

Figure 5. Total Capacitance vs. Reverse Voltage

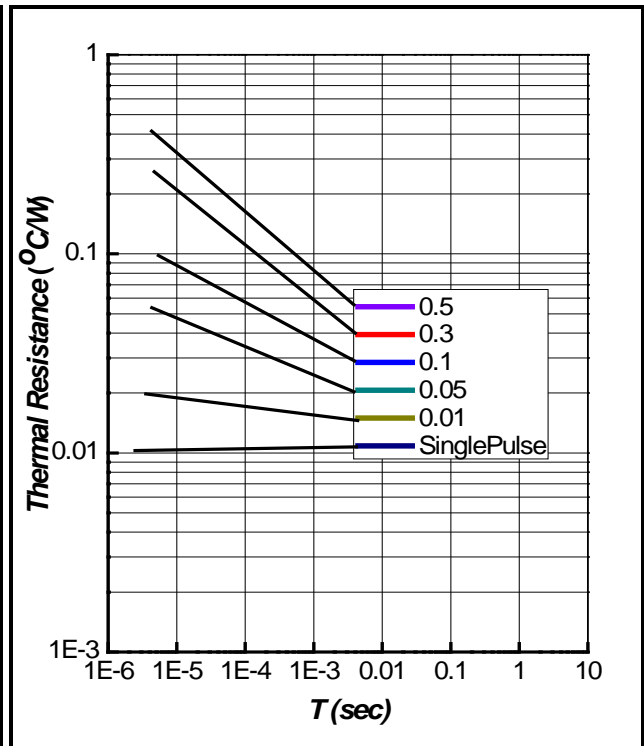
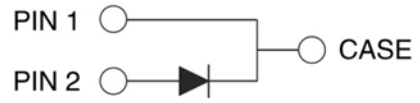
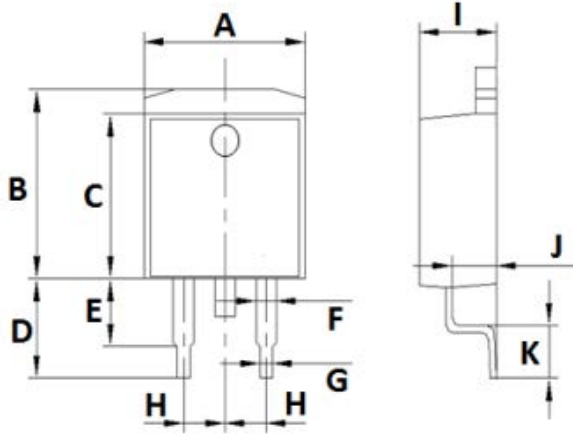

Figure 6. Transient Thermal Impedance

## Package Dimensions

Package TO-263-2



Symbol	Min. (mm)	Typ. (mm)	Max. (mm)
A	9.80	10.10	10.40
B	9.40	9.90	10.40
C	8.46	8.66	8.86
D	4.85	5.35	5.8
E	-	3.20	-
F	1.05	1.25	1.45
G	0.60	0.8	1.00
H	2.34	2.54	2.74
I	4.40	4.65	4.90
J	2.40	2.60	2.80
K	2.30	2.55	2.80

## DISCLAIMER NOTICE

Rectron Inc reserves the right to make changes without notice to any product specification herein, to make corrections, modifications, enhancements or other changes. Rectron Inc or anyone on its behalf assumes no responsibility or liability for any errors or inaccuracies. Data sheet specifications and its information contained are intended to provide a product description only. "Typical" parameters which may be included on RECTRON data sheets and/ or specifications can and do vary in different applications and actual performance may vary over time. Rectron Inc does not assume any liability arising out of the application or use of any product or circuit.

Rectron products are not designed, intended or authorized for use in medical, life-saving implant or other applications intended for life-sustaining or other related applications where a failure or malfunction of component or circuitry may directly or indirectly cause injury or threaten a life without expressed written approval of Rectron Inc. Customers using or selling Rectron components for use in such applications do so at their own risk and shall agree to fully indemnify Rectron Inc and its subsidiaries harmless against all claims, damages and expenditures.