

Silicon PNP Power Transistor

FEATURES

1. High Voltage: $V_{CEO} = -300V$
2. Low Collector Saturation Voltage Capability
3. Complementary to RT340LD
4. Marking :GX350

TO-252



1.Base 2.Collector 3.Emitter

Maximum ratings($T_a=25^{\circ}C$ unless otherwise noted)

Parameter	Symbol	Value	Unit
Collector-Base Breakdown Voltage	V_{CBO}	-300	V
Collector-Emitter Breakdown Voltage	V_{CEO}	-300	V
Emitter-Base Breakdown Voltage	V_{EBO}	-3	V
Collector Current	I_C	-0.5	A
Collector Power Dissipation	P_C	15	W
Junction Temperature	T_J	150	$^{\circ}C$
Storage Temperature	T_{stg}	-55~150	$^{\circ}C$

Electrical Characteristics ($T_a=25^{\circ}C$ unless otherwise noted)

Parameter	Symbol	Test Condition	Min	Max	Unit
Collector-Base Breakdown Voltage	V_{CBO}	$I_C = -1mA$ $I_E = 0$	-300		V
Collector-Emitter Breakdown Voltage	V_{CEO}	$I_C = -10mA$ $I_B = 0$	-300		V
Emitter-Base Breakdown Voltage	V_{EBO}	$I_E = -1mA$ $I_C = 0$	-60		V
Collector Cutoff Current	I_{CBO}	$V_{CB} = -300V$ $I_E = 0$		-100	μA
Collector Cutoff Current	I_{CEO}	$V_{CB} = -150V$ $I_B = 0$		-100	μA
Emitter Cutoff Current	I_{EBO}	$V_{EB} = -6V$ $I_C = 0$		-100	μA
DC Current Gain	HFE(1)	$V_{CE} = -10V$ $I_C = -50mA$	30	240	
Collector-Emitter Saturation Voltage	$V_{CE(sat)}$	$I_C = -100mA$ $I_B = -10mA$		-1	V
Base-emitter voltage	$V_{BE(on)}$	$I_C = -1A$ $V_{CE} = -10V$		-1.5	V
Transition frequency	f_T	$V_{CE} = -10V$ $I_C = -50mA$	10		MHz

RATING AND CHARACTERISTICS CURVES (RT350LD)

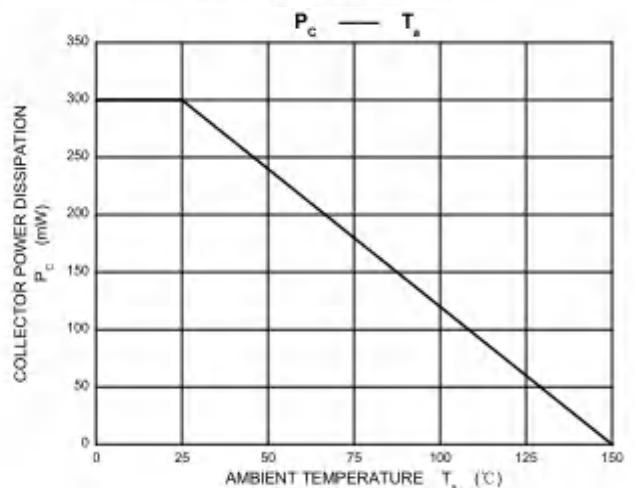
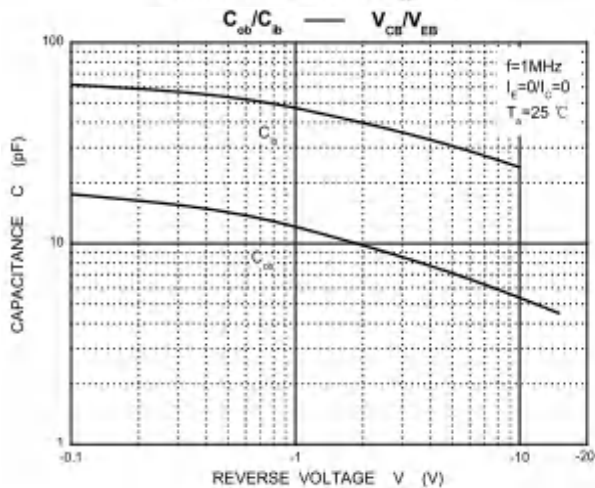
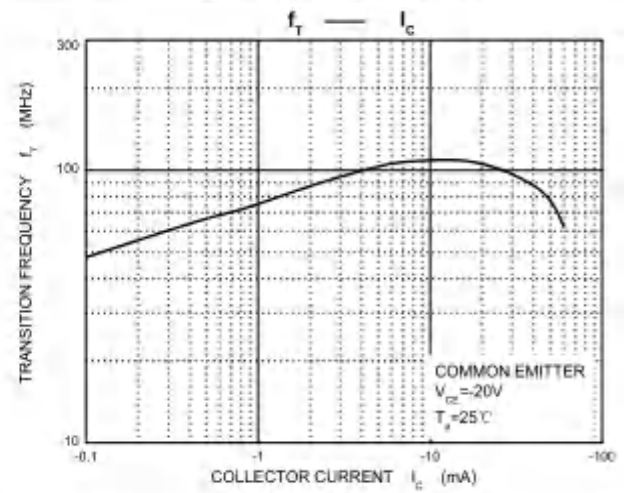
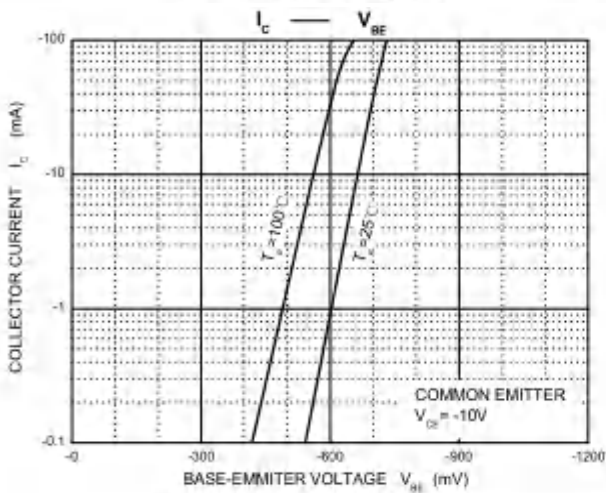
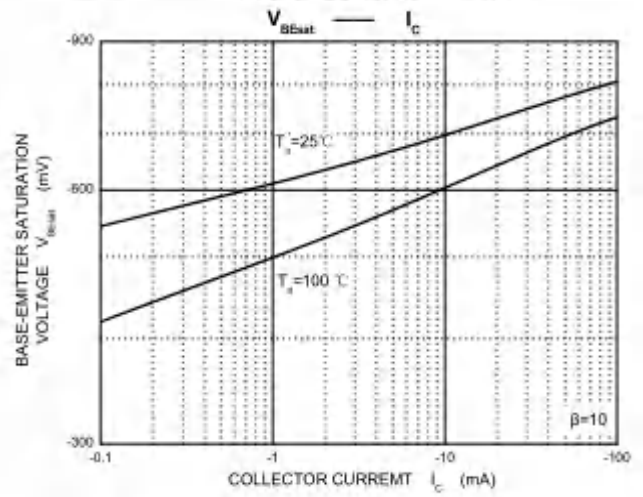
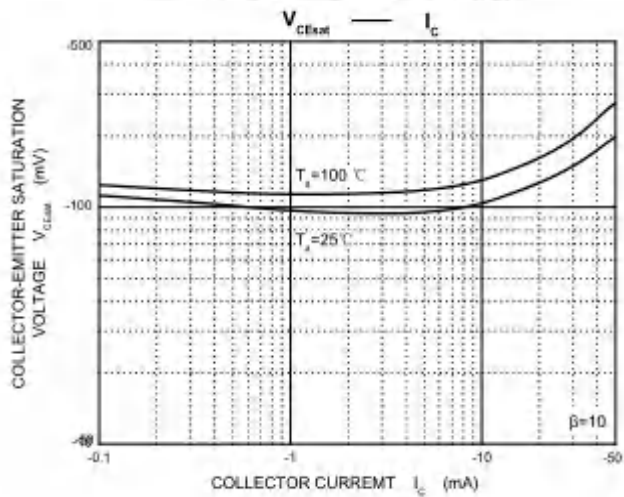
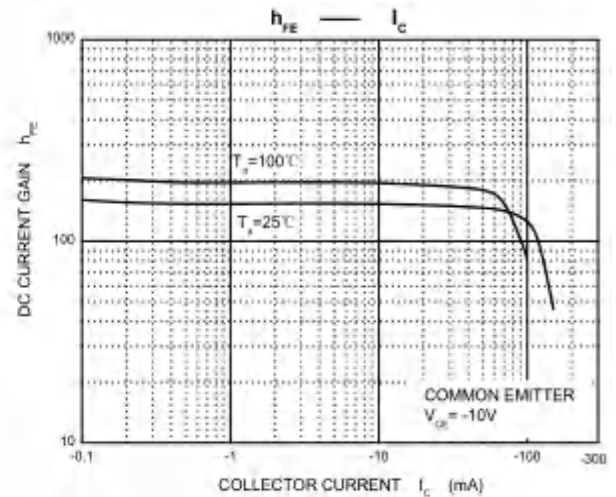
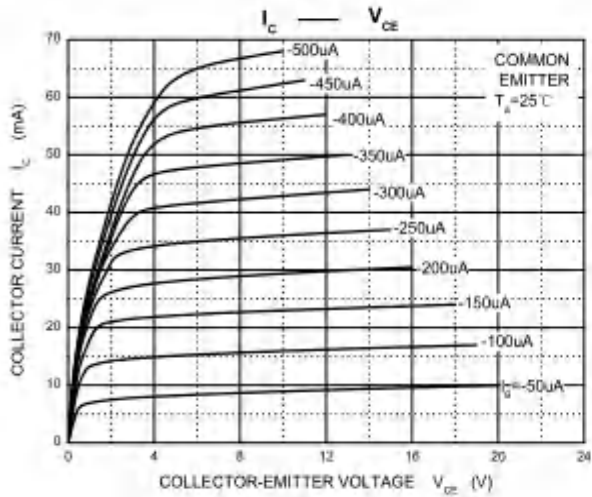

TO-252

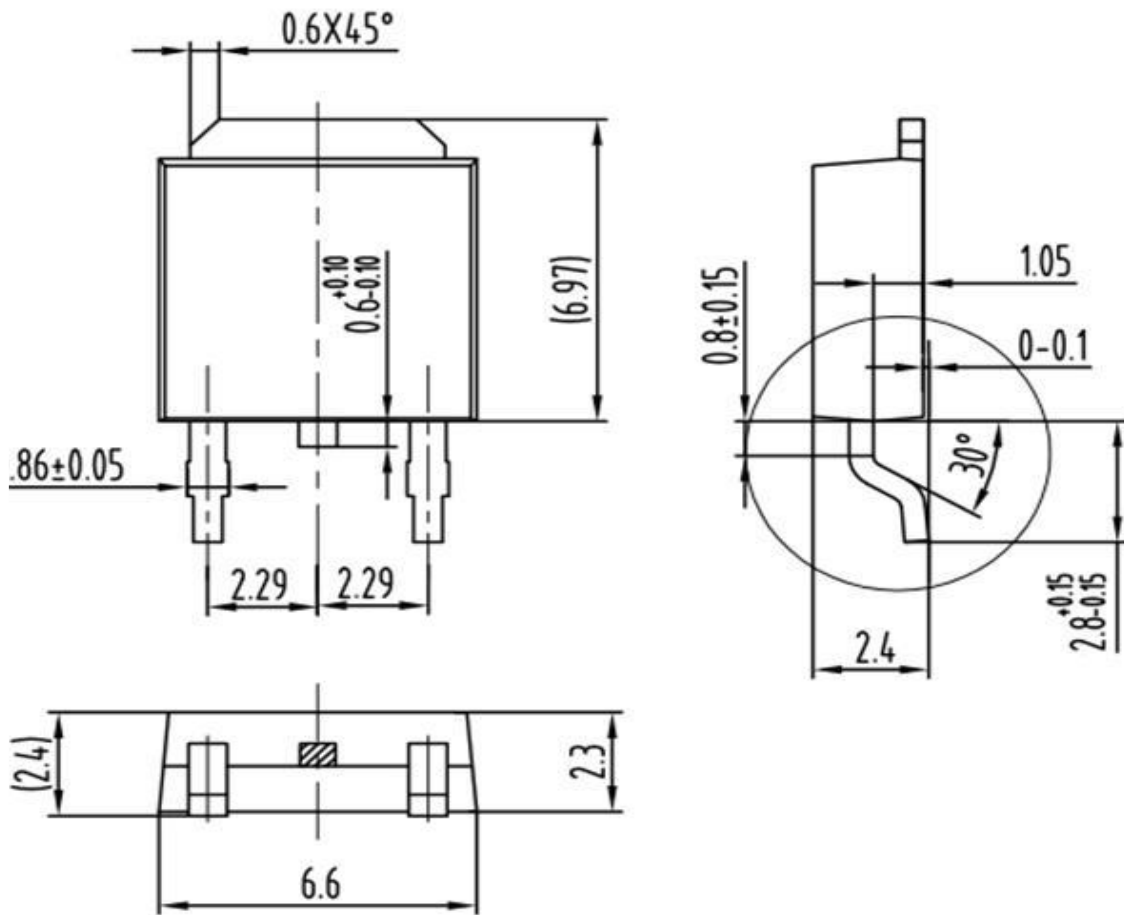

Unit:mm

Note: All unstated tolerances are ± 0.1 mm

PACKAGING OF DIODE AND BRIDGE RECTIFIERS

TUBE PACK

PACKAGE	PACKING CODE	EA PER REEL	EA PER BOX	INNER BOX SIZE (mm)	CARTON SIZE (mm)	EA PER CARTON
TO-252	-T	2500	5000	410*410*45	430*430*390	40000

DISCLAIMER NOTICE

Rectron Inc reserves the right to make changes without notice to any product specification herein, to make corrections, modifications, enhancements or other changes. Rectron Inc or anyone on its behalf assumes no responsibility or liability for any errors or inaccuracies. Data sheet specifications and its information contained are intended to provide a product description only. "Typical" parameters which may be included on RECTRON data sheets and/ or specifications can and do vary in different applications and actual performance may vary over time. Rectron Inc does not assume any liability arising out of the application or use of any product or circuit.

Rectron products are not designed, intended or authorized for use in medical, life-saving implant or other applications intended for life-sustaining or other related applications where a failure or malfunction of component or circuitry may directly or indirectly cause injury or threaten a life without expressed written approval of Rectron Inc. Customers using or selling Rectron components for use in such applications do so at their own risk and shall agree to fully indemnify Rectron Inc and its subsidiaries harmless against all claims, damages and expenditures.